

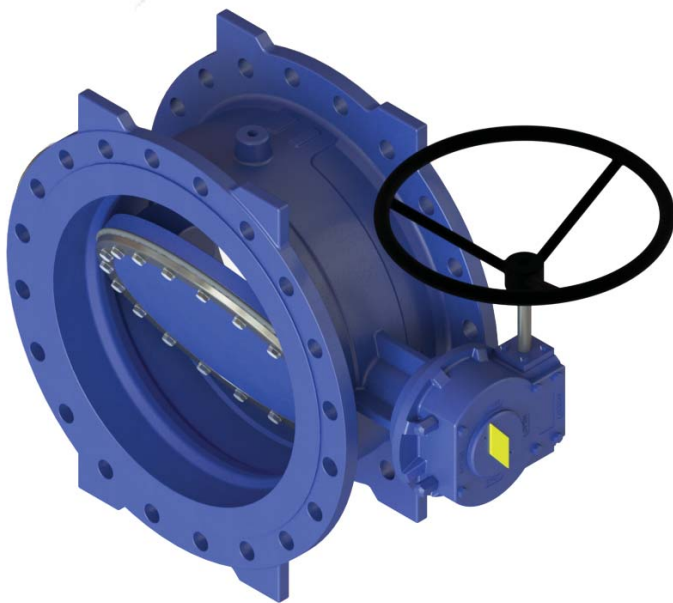

## BUTTERFLY VALVES DOUBLE OFFSET KENNEDY SERIES 614 To EN/ISO Standards

Kennedy valves with its unique features have been used in water and fire protection industry since 1877. Our 61 Series butterfly valves conforms to EN / ISO standards and has been designed to maintain the high quality and integrity of existing designs but incorporates many superior features. The double offset sealing technology with the soft sealing element on the disc to provide high sealing Performance and reliability. Series 61 butterfly valves are made in cast ductile iron body with double flanged design and integral seats and suitable for bidirectional service. Valves are suitable for water and neutral liquids to a maximum temperature of 70°C.



### General Specifications

614 : Double Offset Butterfly Valves Flanged  
Sizes : DN 200 - DN 600  
Working Pressure : 16 Bar

### Design

EN 593, EN 1074-1&2 Standards  
Face To Face EN 558 / ISO 5752 Series 14

### Flanges

EN 1092-2 PN16

### Operator

Worm Gear with hand wheel, IP67  
ISO 5211 Mounting flange standards  
Open and close position indicator

### Test Pressure

Pressure testing to EN 1074-1&2 and EN 12266-1&2  
Seat Test : 1.1 x PN (18 Bar)  
Body Test : 1.5 x PN (24 Bar)

### Coating

Fusion bonded non-toxic epoxy coating NSF 61  
Coated to DIN 30677-2 Standards.

### Options

Replaceable SS 316 seats, Shaft in Duplex SS  
External shaft locking mechanism  
Underground gear operators  
Various material combinations  
PN10 or ANSI 150 drilling  
Electric actuators  
Head stock and extension stems

EPDM Rubber available with NSF61 approval suitable for potable water

# DIMENSIONS AND PART LIST – Butterfly Valve Series 614

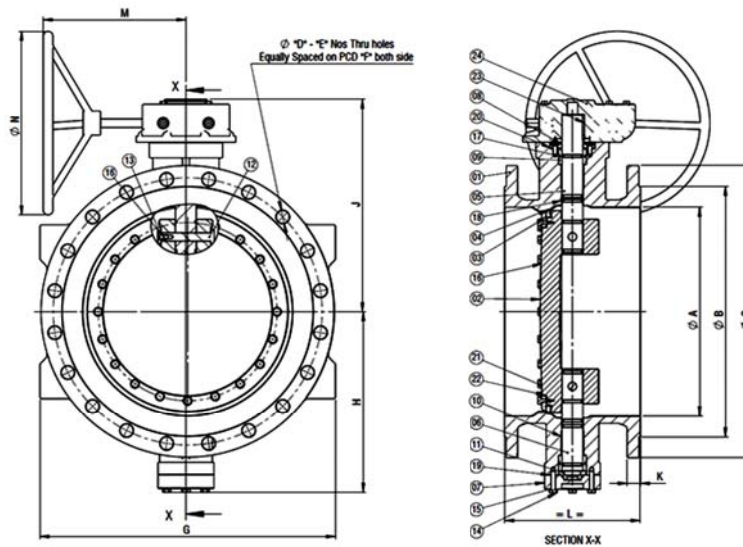

## COMPONENTS

Item No.	Item Description	Material	Item No.	Item Description	Material
1	Body	Ductile Iron EN 1563 EN JS 1050	13	Dowel Pin Washer	SS 316/ EPDM
2	Disc	Ductile Iron EN 1563 EN JS 1050	14	Hex. Screw	ASTM A193 B8M
3	Seat Retainer Ring	SS 316	15	Sealing Washer	SS 316/ EPDM
4	Seat Ring	EPDM	16	CSK Screw (Dowel Pin)	ASTM A193 B8M
5	Upper Shaft	SS 316	17	O' Ring (Bush)	EPDM
6	Lower Shaft	SS 316	18	O' Ring (Stem)	EPDM
7	Bottom Flange	CF8M	19	O' Ring (Bottom Flange)	EPDM
8	Gland Plate	SS 316	20	Gland Gasket	EPDM
9	Bush	PH.BRONZE	21	Hex. Screw	ASTM A193 B8M
10	Plain Bearing	PTFE / SS304	22	O' Ring (Retainer Ring)	EPDM
11	Thrust Washer	PH.BRONZE	23	Key	SS 410
12	Dowel Pin	SS 316	24	Gear Box	

(Materials to trim 601)

## DIMENSIONS (mm) for PN 16

SIZE	L	ØA	ØB	ØC	Flange			ØG	H	J	K	M	ØN	Wt Kgs
					ØD	E Nos	ØF PCD							
DN 200	230	200	266	340	23	12	295	346	210	288	20	257	200	50
DN 250	250	250	319	400	28	12	355	406	235	313	22	257	200	65
DN 300	270	300	370	455	28	12	410	460	274	351	25	275	250	97
DN 350	290	350	429	520	28	16	470	530	318	397	27	275	250	131
DN 400	310	400	480	580	31	16	525	592	333	412	28	280	300	162
DN 500	350	500	609	715	34	20	650	722	422	489	32	336	400	278
DN 600	390	600	720	840	37	20	770	846	521	613	38	397	500	442

Kennedy and McWane Gulf are divisions of McWane Inc. USA

The specifications and material grades shown are subject to revision without notice based on our product improvement programme